



GRANGE TOWER BRIDGE HOTEL

45 Prescott Street, London E1 8GP
Tel: 020 7959 5000 Fax: 020 7959 5100
Email: towerbridge.events@grangehotels.com



FLOOR 1

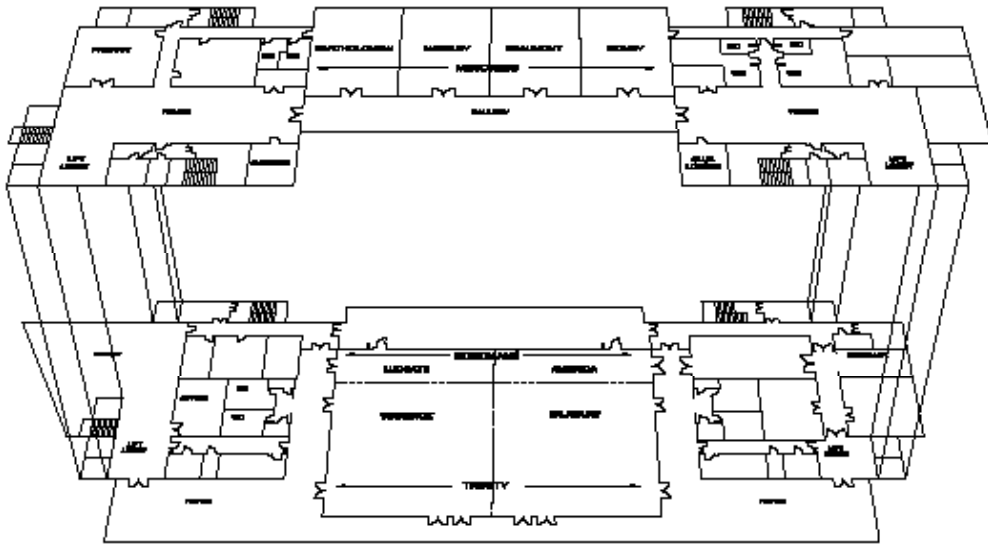

FLOOR -2

Boasting stunning views over London's iconic Tower Bridge and designed using the very best 'green' building materials and systems, the Grange Tower Bridge Hotel is one of the most energy-efficient hotels in London. Eco-friendly features include 'green roofs' with renewable energy panels, energy-efficient Heat, Ventilation and Air Conditioning systems and a borehole for the hotel's own water supply.

Inspirational guest bedrooms incorporate a host of modern amenities, including wireless high-speed internet, Bluetooth-enabled Media Hubs and 3D enabled LED flat screen TVs. Additional in-house services include a comprehensive Business Centre, a luxurious Ajala Spa and a state-of-the-art gymnasium with beautiful 25m pool, steam, sauna and aromatherapy suites.

The Grange Tower Bridge Hotel is perfectly situated by Tower Hill and Tower Gateway stations – providing optimum accessibility to the Square Mile's renowned financial district, Canary Wharf, the Docklands and London's exciting West End.

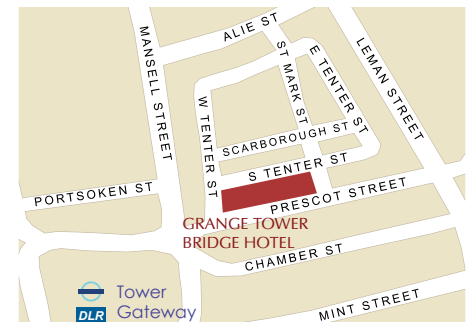



Redefining luxury conference and events facilities within the famous Tower Bridge district, the purpose-built Grange Tower Bridge Events Centre can accommodate up to 1,500 people in a full range of set-ups for both corporate and private events.

Spread over two expansive floors, fully flexible dining, meeting and exhibition suites are complemented by a generous gallery and large foyer areas on each level, offering additional break-out or pre-function space.

The spectacular Trinity banqueting suite boasts 500m² of pillar-free space, together with a state-of-the-art audiovisual system incorporating top-of-the-range HD projectors, video conferencing equipment and full-range speakers, remote-controlled pinspot lighting, portable staging and encrypted WIFI links for optimal functionality. Versatile upper-level meeting rooms also feature stunning floor-to-ceiling windows, HD plasma screen monitors and ambient LED coffers for bespoke lighting effects.

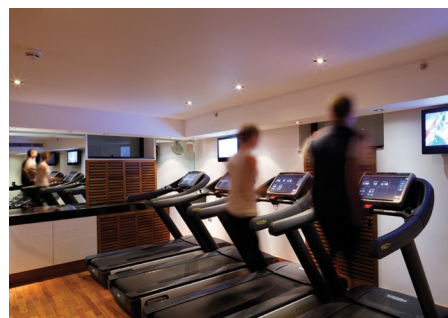

Room Name	Floor	Dimensions			T/S	B/R	C/R	U-S	CAB	D/D	REC
		L(m)	W(m)	H(m)							
Prescot	1	7.99	7.30	2.70	70	18	24	15	-	48	40
Bartholomew	1	11.73	7.81	2.70	120	29	45	30	64	80	150
Harpley	1	11.73	7.81	2.70	120	29	45	30	64	80	150
Beaumont	1	11.73	7.81	2.70	120	29	45	30	64	80	150
Sidney	1	11.73	7.81	2.70	120	29	45	30	64	80	150
Half Minorities	1	15.62	11.73	2.70	240	48	90	40	120	160	300
Minorities	1	31.24	11.73	2.70	400	96	156	105	256	324	600
Garrick	1	3.45	4.78	2.28	12	10	-	-	8	0	25
Trinity & Goodmans	-2	31.04	20.83	4.25	850	-	450	-	432	648	-
Trinity	-2	31.04	16.20	4.25	650	88	250	178	320	480	850
Warwick	-2	15.52	16.20	4.25	320	43	120	53	160	240	420
Salisbury	-2	15.52	16.20	4.25	320	43	120	53	160	240	420
Goodmans	-2	31.04	4.63	2.25	200	88	64	-	104	108	240
Ludgate	-2	15.52	4.63	2.25	90	37	28	-	44	48	120
America	-2	15.52	4.63	2.25	90	37	28	-	44	48	120
Atrium	-2	16.07	12.89	11.28	-	-	-	-	-	-	300